

Dispenser: 02.1510.02
THSG
heating element 230V-400W

Dimensions: weight (empty): 14 kg
A x B = flange
E x F = cut out tube
l x b = tube internal
H = build in height
G = flange height
S = effective stacking height
p x q = operating panel
c = build in depth operating panel
y x z = cut out operating panel
m x n = screw-hole centres
operating panel

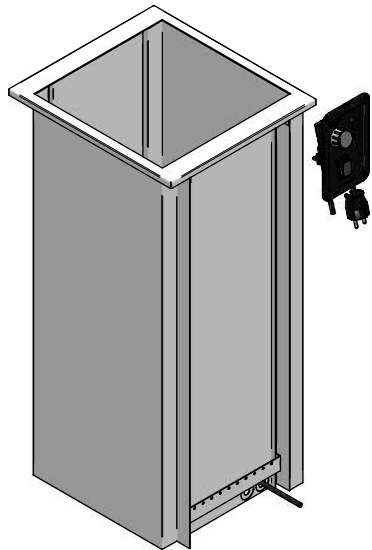

EN

VR :

IR :

MOBILE CONTAINING

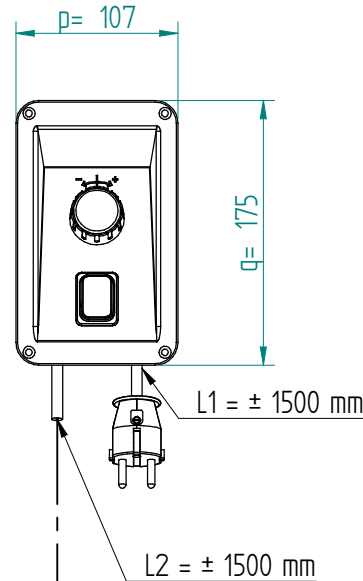
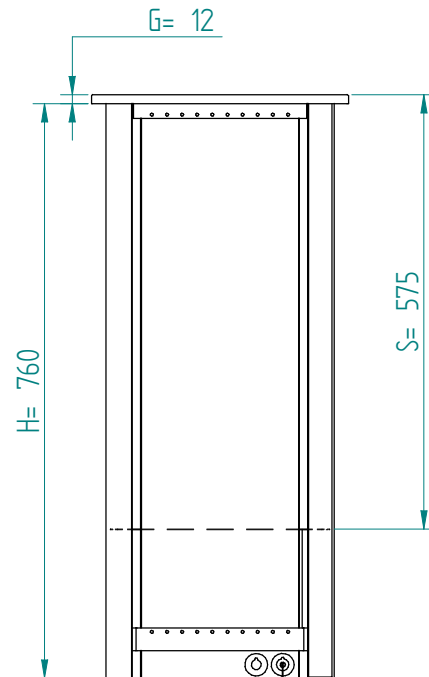
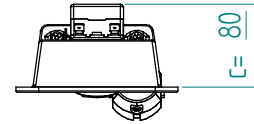
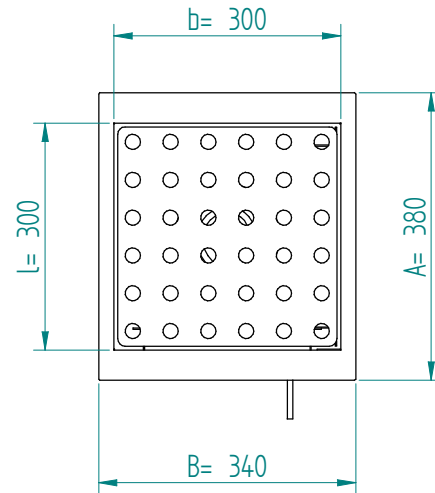

options, order separate;
stst cover: 92.5140

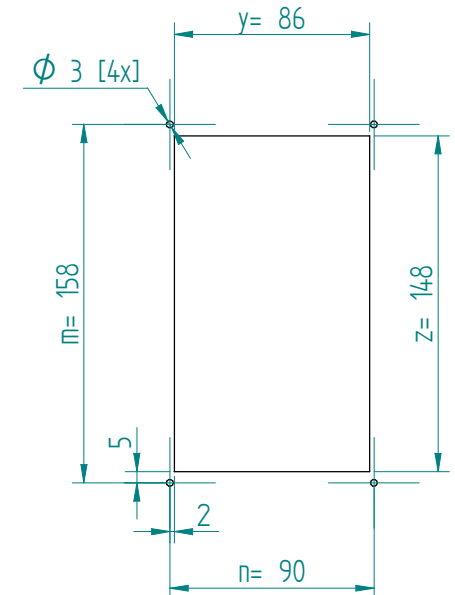
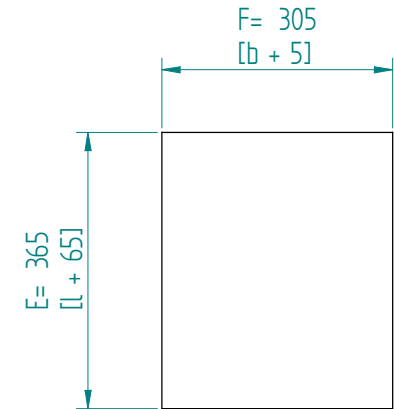
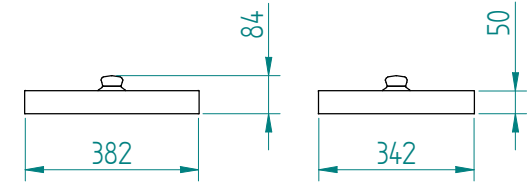

L1 = length cable with plug
L2 = length cable between tube and operating panel