

Dispenser: 02.1513.NC DFR 210 heated  
heating element 230V-400W

Crockery:

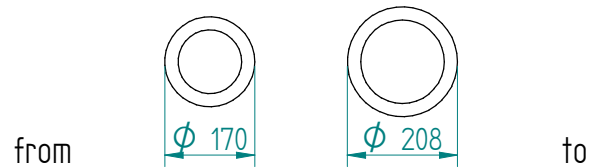

Dimensions: weight (empty): 9 kg

A = flange

E = cut out

H = build in height

S = effective stacking height

y x z = cut out operating panel

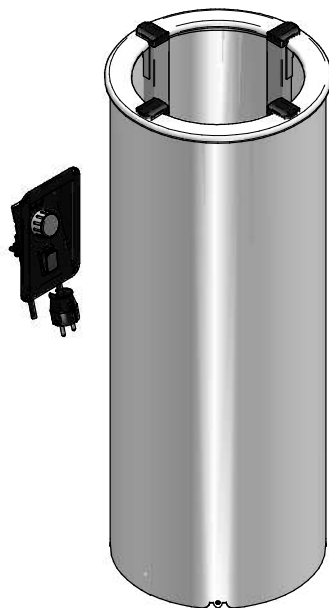

EN

VR :

IR :

**MOBILE CONTAINING**

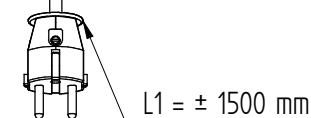
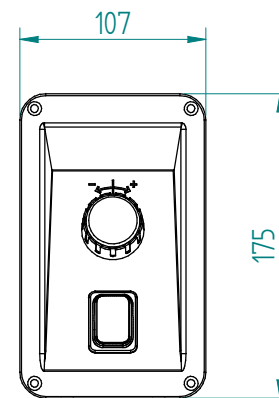
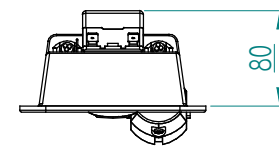
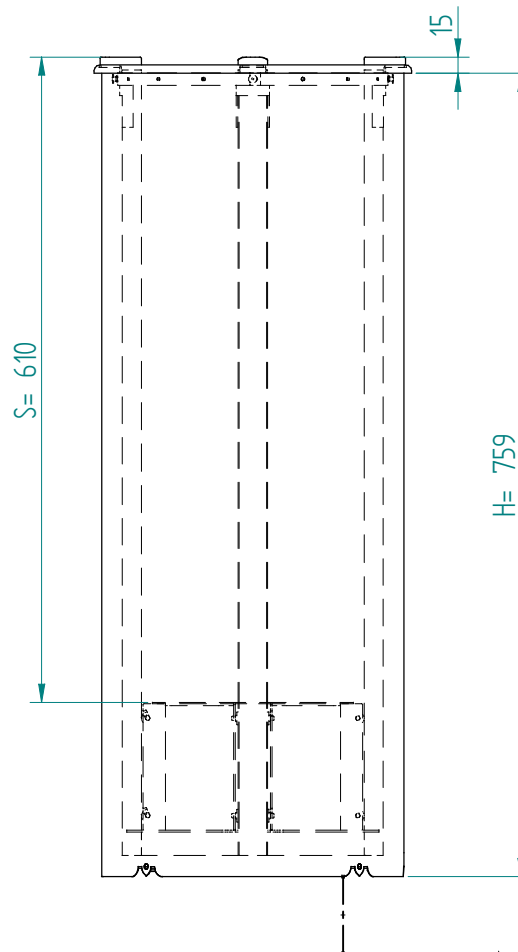
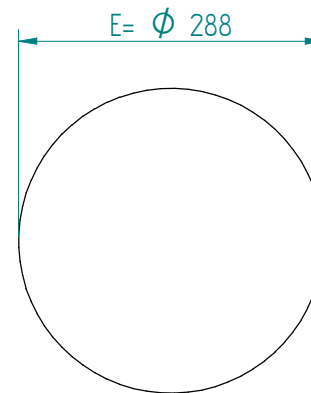
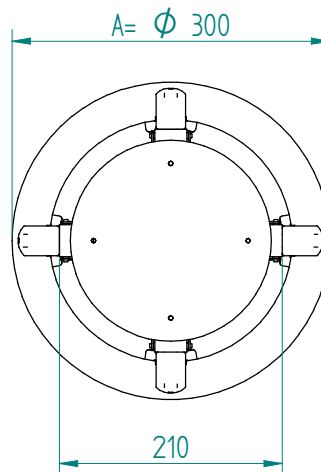

L2 = ± 1500 mm

options, order separate;  
pc cover: 91.5011

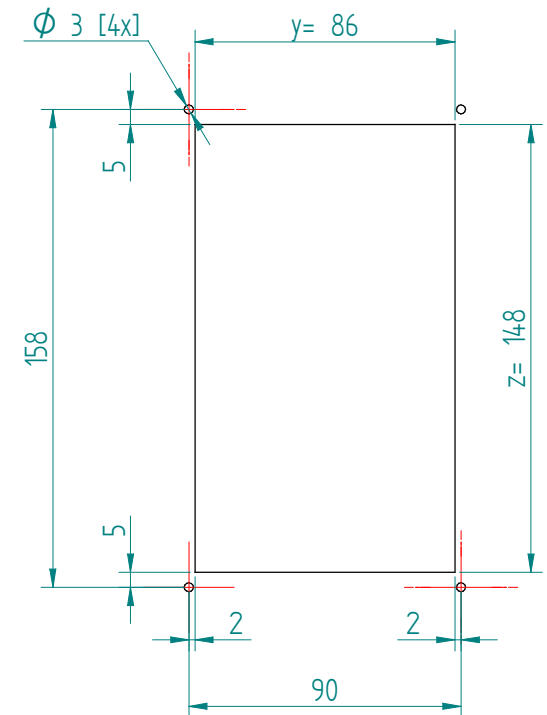
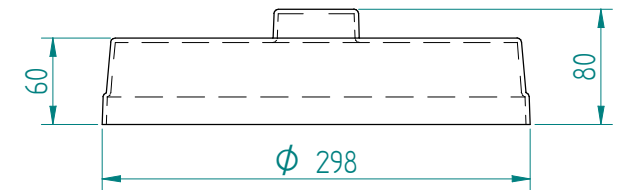

L1 = length cable with plug

L2 = length cable between tube and operating panel